

Hallweld Bennett's standard **SURECLIP UNIVERSAL FIXING CLIP SET** (Code SC001MG) is a galvanised clip that consists of four components.

- 1 x Clip Top
- 1 x M8 x 65 Bolt for grating with Load Bars up to 40mm
- 1 x M8 Nut
- 1 x Bottom Bracket that captures the nut

These components enable fast and secure fixing of grating to steel support sections and mean that the fixing can be performed from the top of the grating. Please note that for 45mm and 50mm grating, we supply an M8 x 80 bolt and nut and that the code for this product is SC003MG.

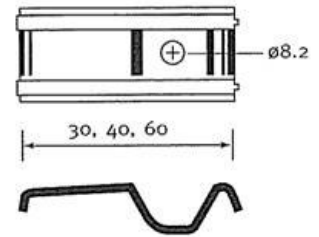

**UNIVERSAL FIXING CLIP SADDLE (SC100MG)**

Designed to be used with Mild Steel, Stainless Steel and Aluminium grating in all our patterns

## OTHER FIXING CLIPS AVAILABLE THROUGH HALLWELD BENNETT

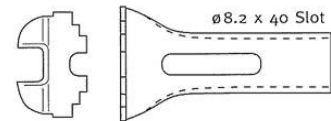

**UNIVERSAL FIXING CLIP BOTTOM (SC200MG)**

This is the bottom section of our **SURECLIP UNIVERSAL FIXING CLIP**. It is available in either galvanised mild steel or mill finish stainless steel.

**SC130SM FRP FIXING CLIP**

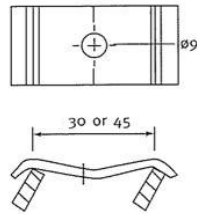
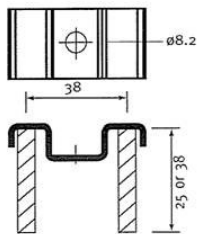

**EXPANDED METAL FIXING CLIP**

Designed to be used with Expanded Metal products, this clip is available in two sizes. The **SCEM30** is for SWM 30 and the **SCEM45** is for SWM 45.

**SC131SM and SC132SM FRP FIXING CLIP**

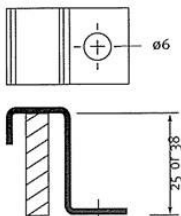

**SC133SM (25mm) and SC134SM (38mm) FRP FIXING CLIP**

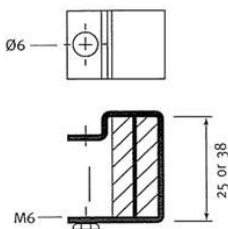

The three clips shown above are designed to be used with Fibre Reinforced Plastic (FRP) grating. FRP clips are manufactured from T316 stainless steel. The SC130 is used in 95% of applications.

## FASTENING SCREWS

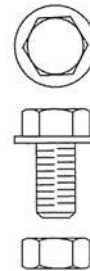

**SC300MG (Galvanised Mild Steel) or SC300SM (Stainless Mill Finish)**

This is the standard M8x65 bolt and nut set which goes with our **SURECLIP UNIVERSAL FIXING CLIP**. It is available in either galvanised mild steel or mill finish stainless steel. Other bolt and rivet sets are also available to suit the Fixing Clips shown on this page.



**80 x 8**

This bolt and nut set is available in galvanised mild steel (**SC303MG**) or mill finished stainless steel (**SC303SM**)

**50 x 8**

This bolt and nut set is available in mill finished stainless steel (**SC304SM**)



**SC310SM (20 x 6)**

**SC311SM (30 x 6)**

**SC312SM (50 x 6)**

The above bolt and nut sets are in mill finished stainless steel.



**SC302MG**

This screw is 50 x 8 and requires a pilot hole of 7.4mm

CLIP SET NAME	GRATING PATTERN	DESCRIPTION OF CLIP	COMPRISES	FOR USE WITH
SC001MG	SG *** / 30 / 100 M SG *** / 30 / 50 M SG *** / 40 / 100 M SG *** / 40 / 50 M SG *** / 60 / 50 M	Universal Clip Set Standard Screw Galvanised Mild Steel Suits All Patterns	Universal Top Universal Bottom Universal M8 Screw (65mm) All in Mild Steel	Mild Steel Grating Max 40mm Load Bar Flange Present
SC001SM	SG *** / 30 / 100 S & A SG *** / 30 / 50 S & A SG *** / 40 / 100 S & A SG *** / 40 / 50 S & A SG *** / 60 / 50 S & A	Universal Clip Set Standard Screw Stainless Steel Mill Finish Suits All Patterns	Universal Top Universal Bottom Universal M8 Screw (65mm) All in Stainless Steel	Stainless Steel or Aluminium Grating Max 40mm Load Bar Flange Present
SC002MG	SG *** / 30 / 100 M SG *** / 30 / 50 M SG *** / 40 / 100 M SG *** / 40 / 50 M SG *** / 60 / 50 M	Universal Clip Set Non-Standard Screw Galvanised Mild Steel Suits All Patterns	Universal Top SC302MG 50x8 Screw All in Mild Steel	Mild Steel Grating Max 40mm Load Bar No Flange Present
SC003MG	SG *** / 30 / 100 M SG *** / 30 / 50 M SG *** / 40 / 100 M SG *** / 40 / 50 M SG *** / 60 / 50 M	Universal Clip Set Longer M8 Screw Galvanised Mild Steel Suits All Patterns	Universal Top Universal Bottom SC303MG 80x8 Screw All in Mild Steel	Mild Steel Grating Over 40mm Load Bar Flange Present
SC003SM	SG *** / 30 / 100 S & A SG *** / 30 / 50 S & A SG *** / 40 / 100 S & A SG *** / 40 / 50 S & A SG *** / 60 / 50 S & A	Universal Clip Set Longer M8 Screw Stainless Steel Mill Finish Suits All Patterns	Universal Top Universal Bottom SC303SM 80x8 Screw All in Stainless Steel	Stainless Steel or Aluminium Grating Over 40mm Load Bar Flange Present
SC004SM	SG *** / 30 / 100 M SG *** / 30 / 50 M SG *** / 40 / 100 M SG *** / 40 / 50 M SG *** / 60 / 50 M	Universal Clip Set Non-Standard Screw Stainless Steel Mill Finish Suits All Patterns	Universal Top Universal Bottom SC304SM 50x8 Screw All in Stainless Steel	Aluminium Grating Max 40mm Load Bar Flange Present
SCEM30	EM50075 EM50105	Expanded Metal Clip Set		Expanded Metal (EM) Short Way Mesh 30
SCEM45	EM50080 EM50110	Expanded Metal Clip Set		Expanded Metal (EM) Short Way Mesh 45
SCFRPJ1SM	FRP256***	FRP Clip Set Stainless Steel Mill Finish	SC133SM Top Clip SC311SM Screw	FRP Grating 25mm Deep
SCFRPJ2SM	FRP386***	FRP Clip Set Stainless Steel Mill Finish	SC134SM Top Clip SC312SM Screw	FRP Grating 38mm Deep
SCFRPL1SM	FRP256***	FRP Clip Set Stainless Steel Mill Finish	SC131SM Top Clip SC310SM Screw	FRP Grating 25mm Deep
SCFRPL2SM	FRP386***	FRP Clip Set Stainless Steel Mill Finish	SC132SM Top Clip SC310SM Screw	FRP Grating 38mm Deep
SCFRPM1SM	FRP256***	FRP Clip Set Stainless Steel Mill Finish	SC130SM Top Clip SC311SM Screw	FRP Grating 25mm Deep
SCFRPM2SM	FRP386***	FRP Clip Set Stainless Steel Mill Finish	SC130SM Top Clip SC312SM Screw	FRP Grating 38mm Deep